

Application : Lawn Mower、Portable Power Tool、Sanitizer Spray Machine

用途：智能割草機、電動工具、噴霧器

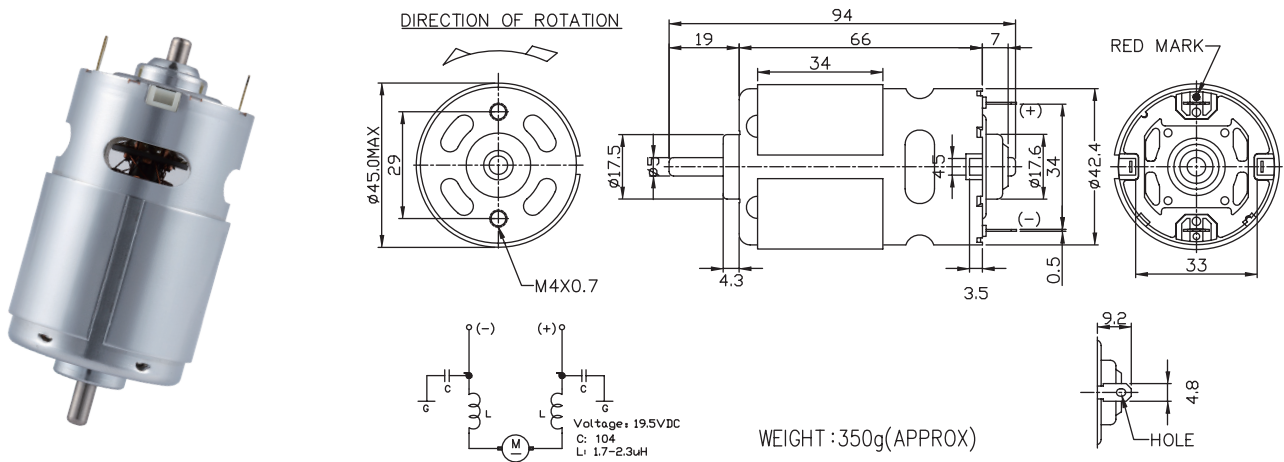

MODEL	VOLTAGE		NO LOAD		AT MAXIMUM EFFICIENCY					STALL			
	OPERATING RANGE	NOMNAL	SPEED rpm	CURRENT A	SPEED rpm	CURRENT A	TORQUE g-cm	TORQUE mN-m	OUTPUT W	EFF %	CURRENT A	TORQUE g-cm	TORQUE mN-m
775-3559-R	6.0 - 36.0	24.0V CONSTANT	7000	0.50	5862	2.19	620	61	37.32	72	14.03	4519	443
775-3764-R	12.0 - 36.0	12.0V CONSTANT	3000	0.25	2523	1.12	382	37	9.90	74	8.15	3205	314
775V-9011F-R-NF	6.0 - 12.0	12.0V CONSTANT	18000	5.00	16287	10.5	1052	103	175.96	81	130.75	8814	864
775W-9012F-R-CE-IE	6.0 - 18.0	18.0V CONSTANT	22000	4.60	18939	1.74	1741	171	338.61	79	151.67	12920	1267

馬達的出軸長度及性能參數，EMC 對策可依客人要求做調整，詳情可詢問相關業務人員。
Please inquire your sales representative for output, performance and EMC solution.

